

# **User Guide**

## **2 Stage 2-3 CIM**

### **EVO Slim**

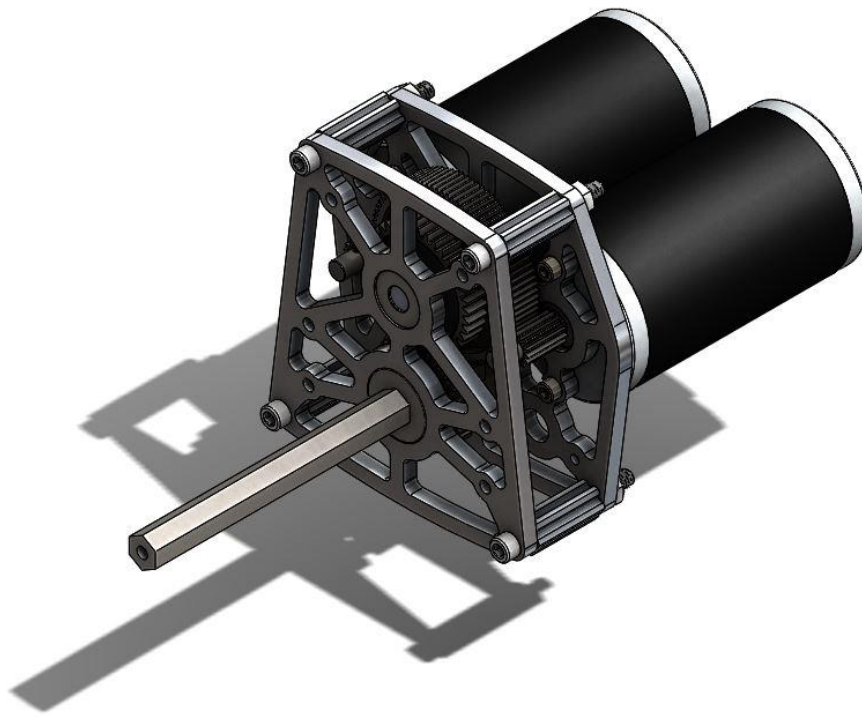

## **EVO Slim with 10.886:1 Shown (am-3804 108)**

**Step 1:** Carefully press the 15T Pinion Gear (am-3482) onto the CIM Motor (am-0255). Be sure to leave a small (~7/32" or 5mm) gap between the pinion and the output shaft bushing.

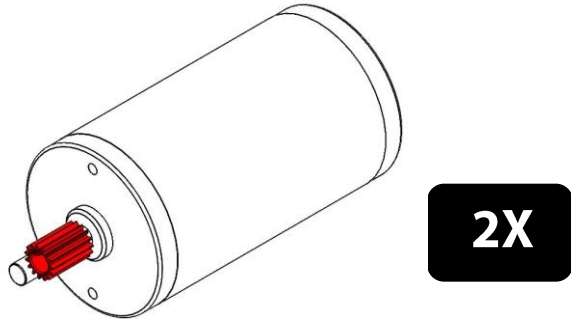

**Step 2:** Press FR6ZZ bearing (am-0028) into the top hole of the Evo 2 Stage 2 Motor Shifter Motor Plate (am-3526)

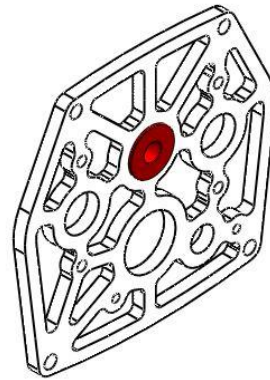

**Step 3:** Press FR6ZZ-L bearing (am-0573) into the bottom hole of the Evo 2 Stage 2 Motor Shifter Motor Plate

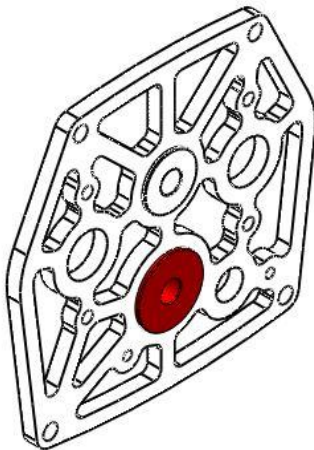

**Step 4:** Insert two to three CIM motors to the Evo 2 Stage 2 Motor Shifter Motor Plate. The motors go on the opposite side of the bearing flange

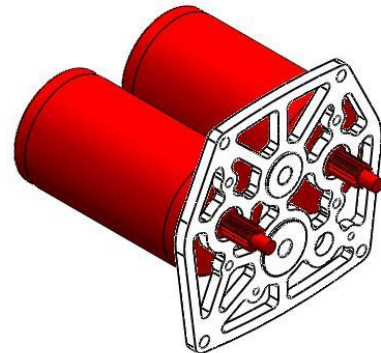

**Step 5:** Mount the two motors with four SHCS 10-32 x 625 (am-1120)

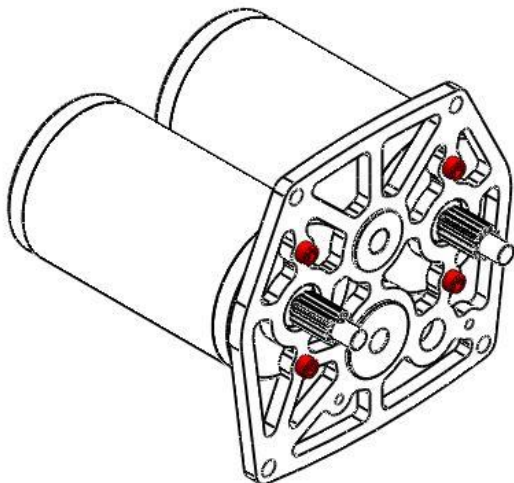

**Step 6:** Place Cluster Shaft for 2 Stage EVO Slim (am-3814) into the FR6ZZ bearing.

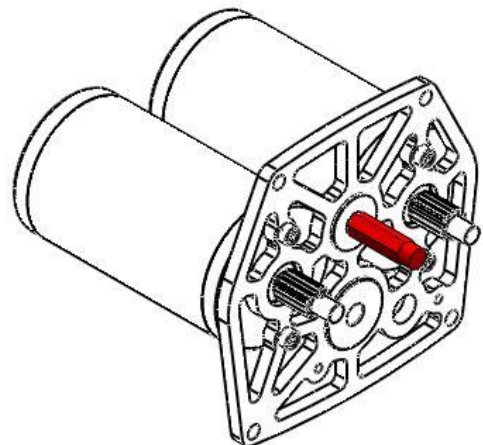

**Step 7:** Slide 85T gear (am-3533) onto the cluster shaft. The 85T gear and the two pinion gears will mesh.

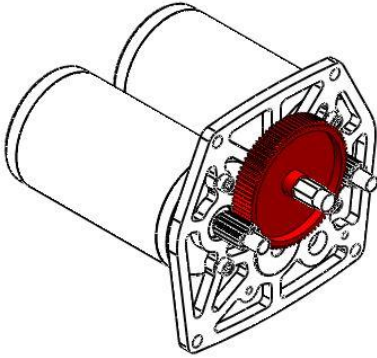

**Step 8:** Place 24T gear (am-3485) onto the cluster shaft.

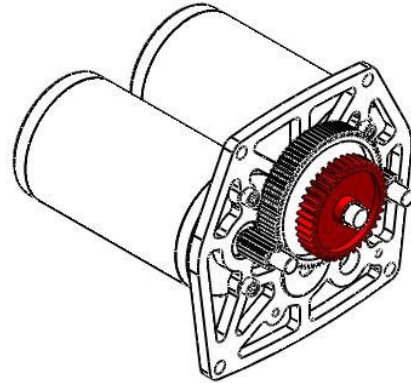

**Step 9:** Install E-clip on the hex shaft

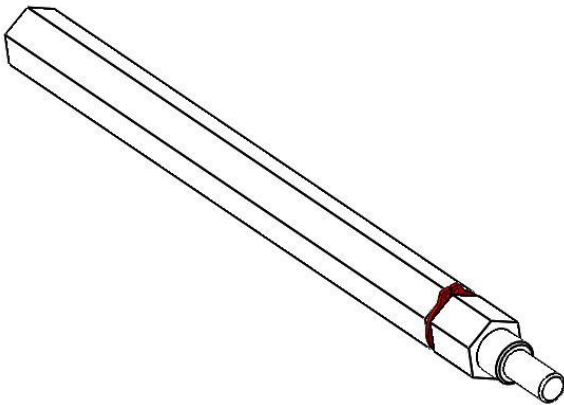

**Step 10:** Place Long Hex Output Shaft (am-0801a\_ring) into FR6ZZ-L bearing.

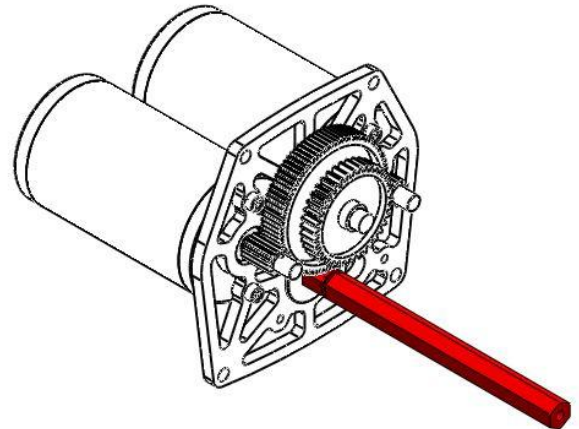

**Step 11:** Slide Acetal Hex Spacer (am-1364) onto Long Hex Output Shaft.

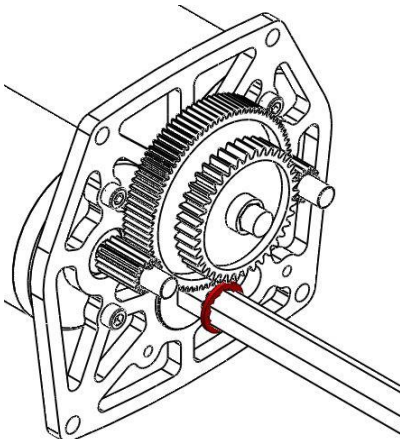

**Step 12:** Slide 46T gear (am-3819) onto Long Hex Output Shaft.

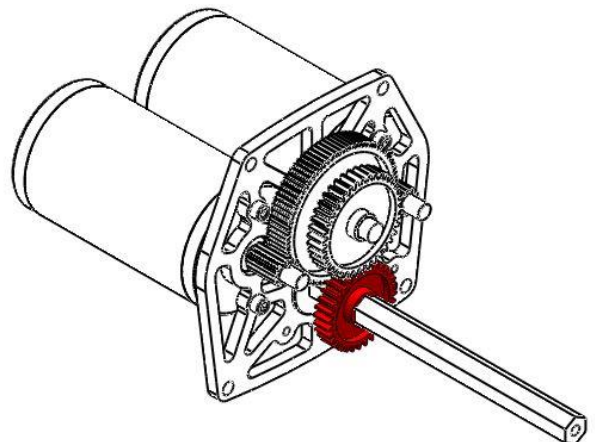

**Step 13:** Press the FR6ZZ Bearing (am-0028) into the top hole of the EVO 2 Stage Output Plate (am-3528)

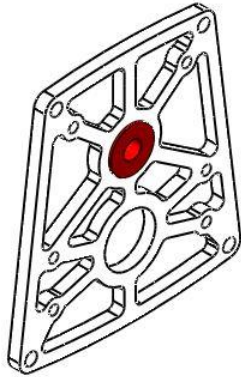

**Step 14:** Press the FR8ZZ-Hex Bearing (am-2986) into the bottom hole of the EVO 2 Stage Output Plate

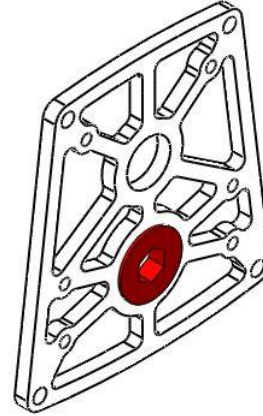

**Step 15:** Slide the output plate over the hex shaft. Bearings faced toward the gears. Press all the way until both shafts are seated into the bearings

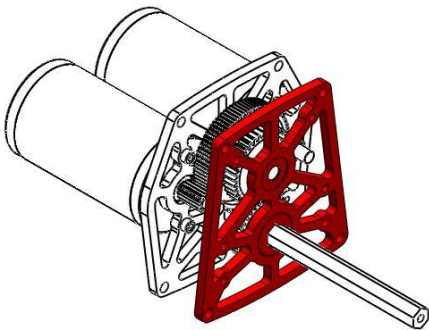

**Step 16:** Place Churro Spacer (am-3813) in between the motor plate and the output plate.

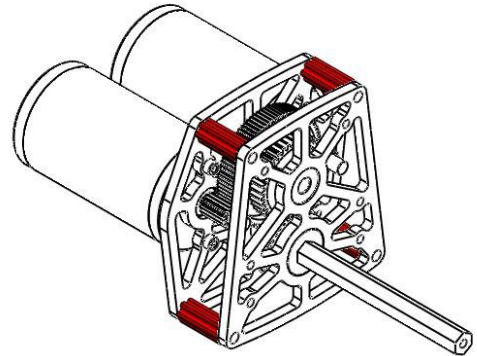

**Step 17:** Thread FHCS 1/4-20 x 2500 (am-1031) in through the output plate, Churro Spacer (am-3813) then the motor plate

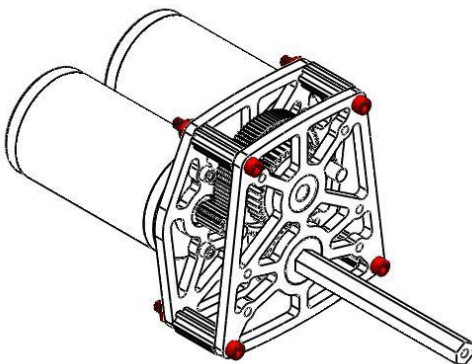

**Step 18:** Tighten the screws with 1/4-20 Nylock Nut (am1015)

